

WiFi Alarm Security Camera

Setup Guide

Thank you purchasing our WiFi Alarm Security Camera! Follow this guide to connect your new camera to your WiFi network, add it to your phone for remote monitoring, and adjust the camera settings. You will require the DMSS app on your phone, and a DMSS account.

Initial Setup

Step 1

Plug in your camera. When deciding on a place to mount the camera, keep in mind that the camera is weatherproof, but the power supply is not. The camera light will flash red, and then flash green. The camera will say “WiFi hotspot is enabled”.

Step 2

Install/open the DMSS app on your phone. Tap the “+” icon in the top right corner, or wherever it is on your app. Select “SN/Scan”.

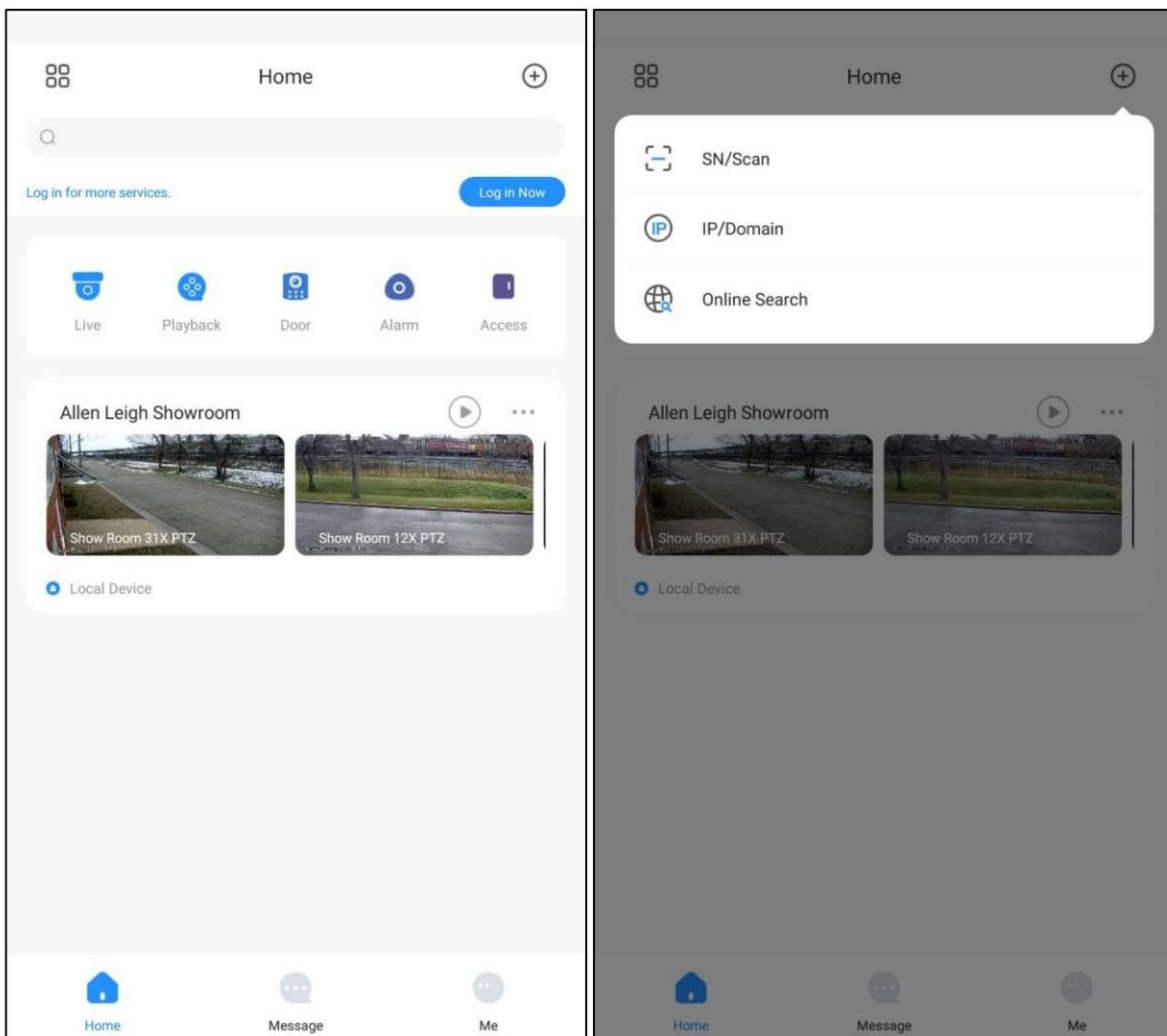

Step 3

Scan the QR code located on the tag at the end of the power cord, by the power supply. You can also manually enter the serial number from the tag or camera box.



Step 4

The WiFi Alarm Security Camera must be added to a DMSS account. Sign in or create an account to continue the process.

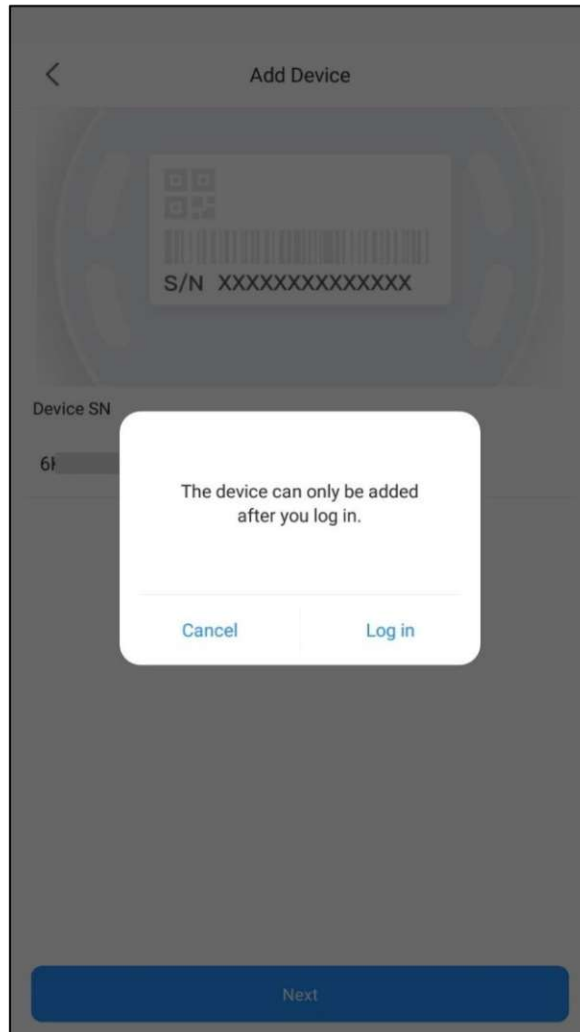

Step 5

After creating an account or adding the camera to your account, tap “Next”.



Step 6

The camera will do something.

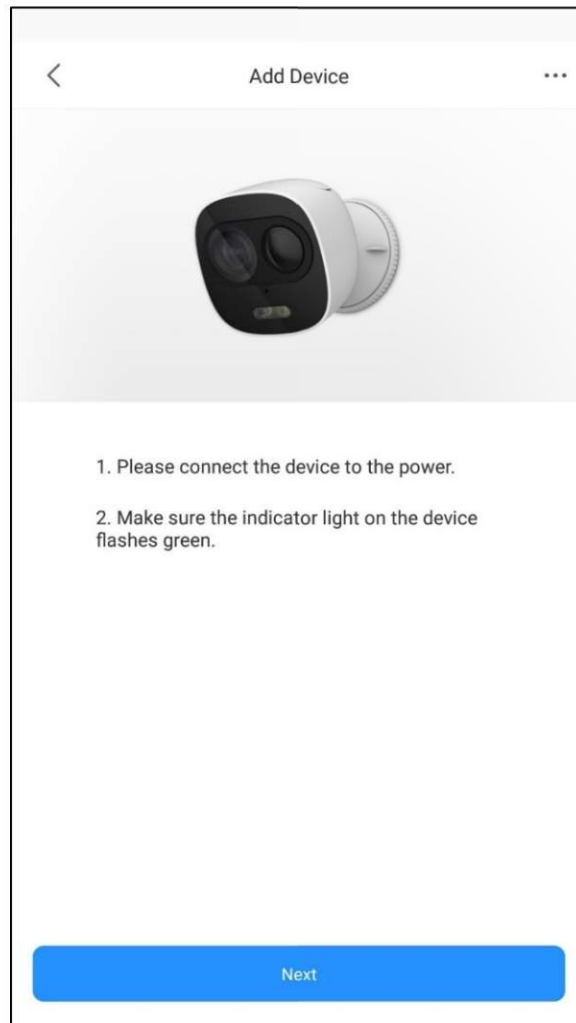

Step 7

The app will attempt to connect your phone to the camera's WiFi network. If it doesn't connect, you can tap "Please try again" or manually select the connection by tapping "Set".

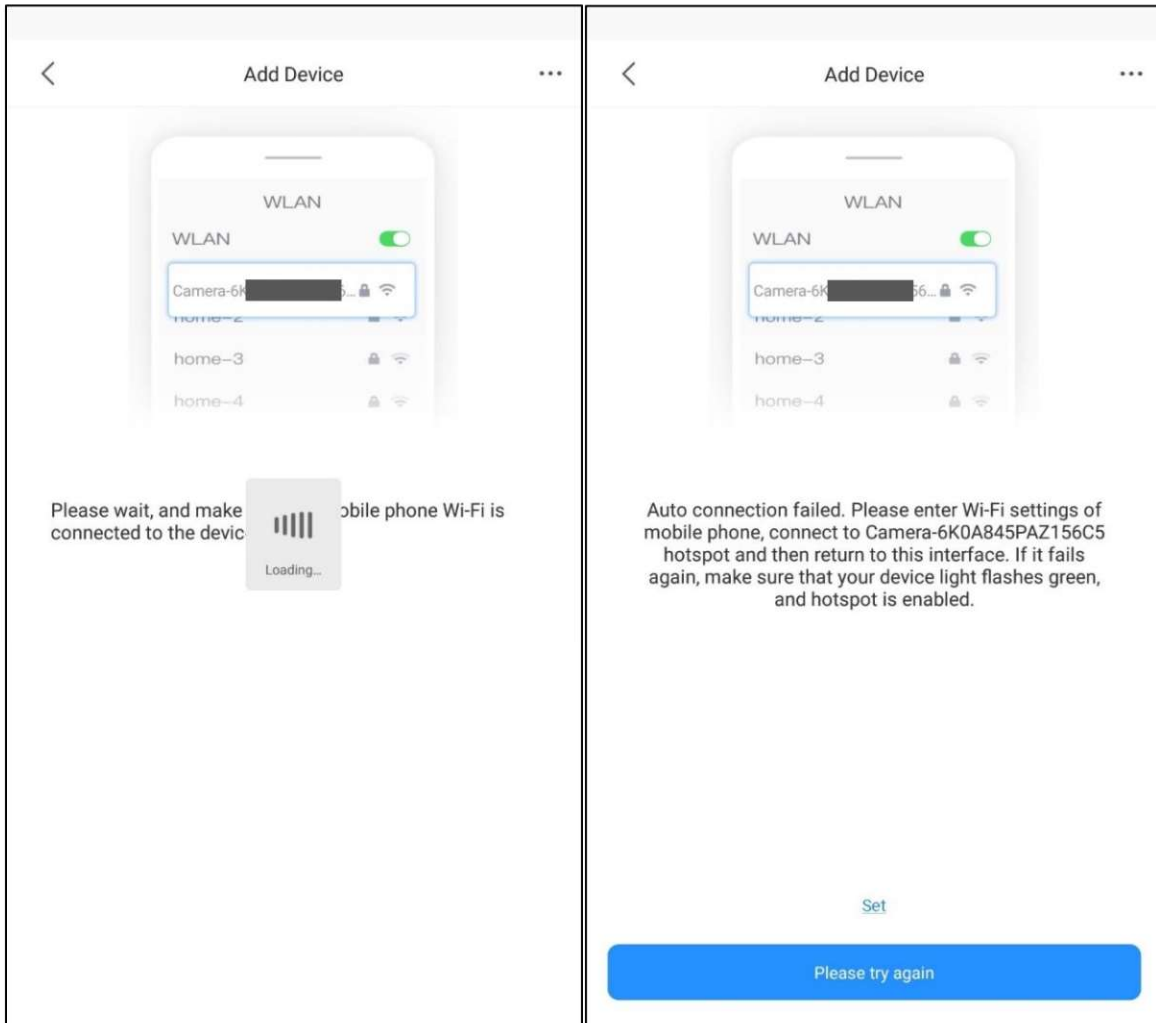

Step 7.1

To manually select the connection, tap the WiFi network named “Camera-#####”, where “#####” is the camera serial number.

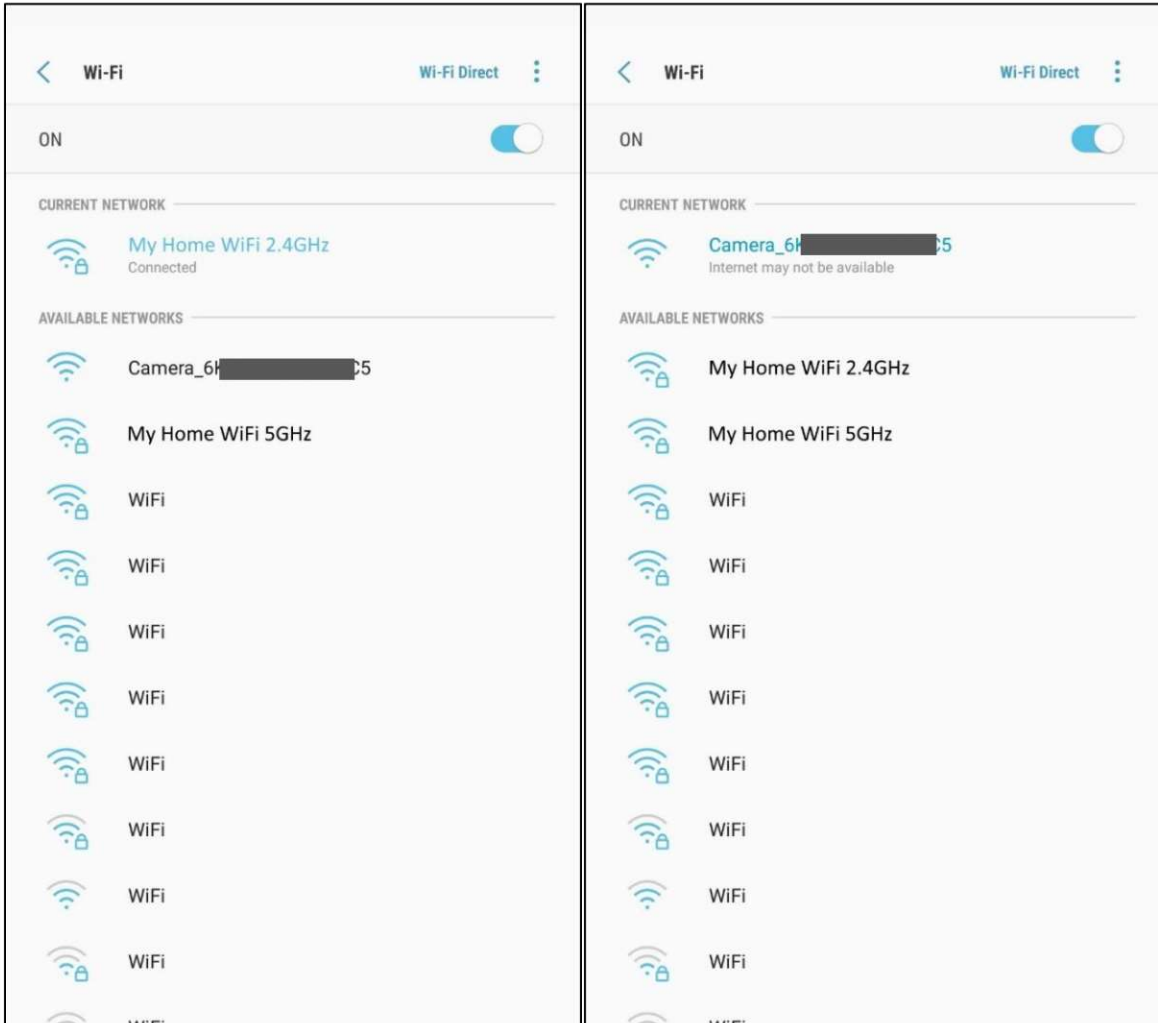

Step 8

The app will detect what country you are in. Tap “I know”. You need to set a password for the camera. You can also add an email address, for resetting the password if it is forgotten. Then tap “OK”.

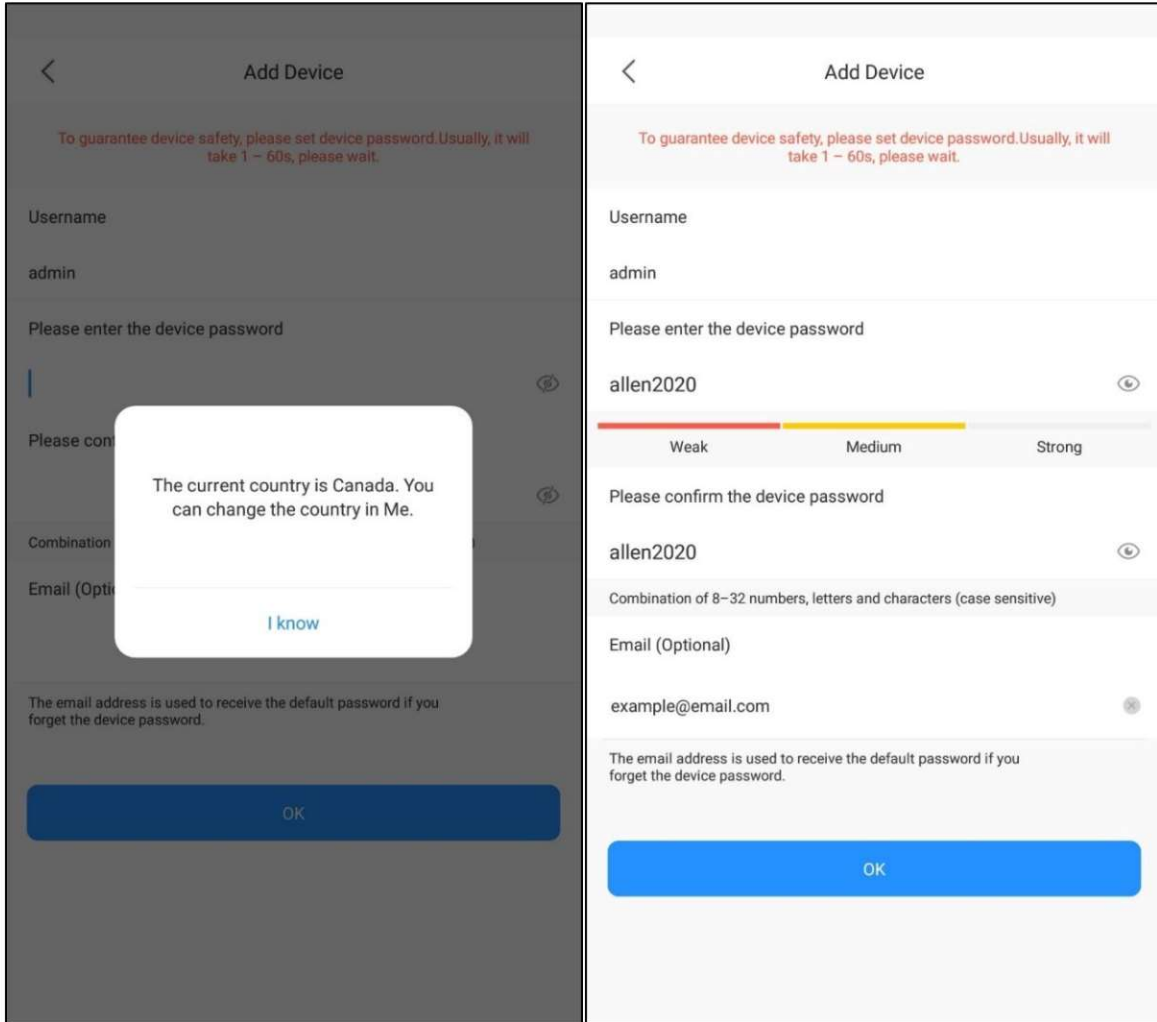

Step 9

The camera needs to connect to your WiFi network. If you have two connections for 2.4GHz and 5GHz, select the 2.4GHz network. Enter your WiFi password to connect the camera.

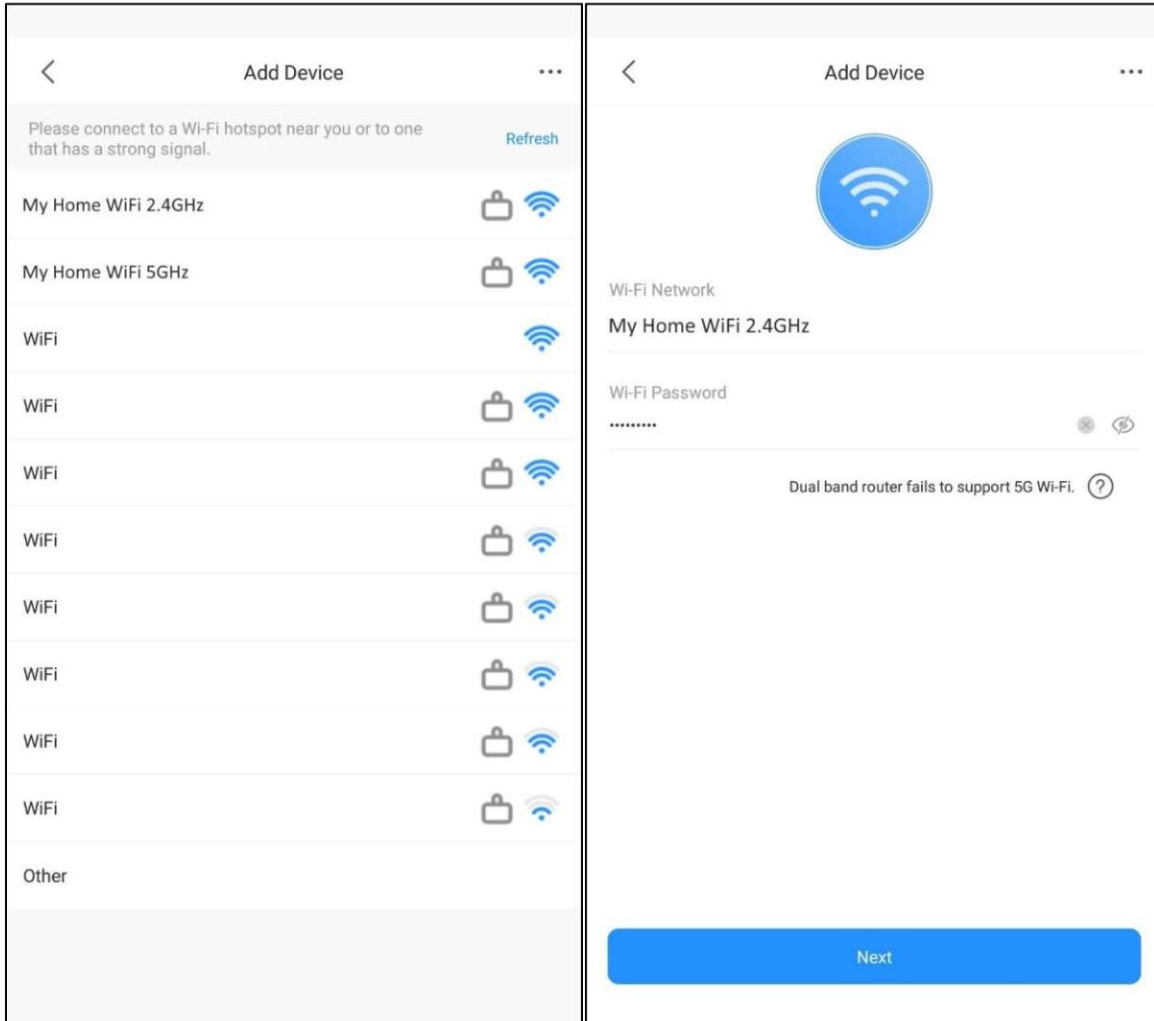

Step 10

The camera will take up to a minute to connect to the network.

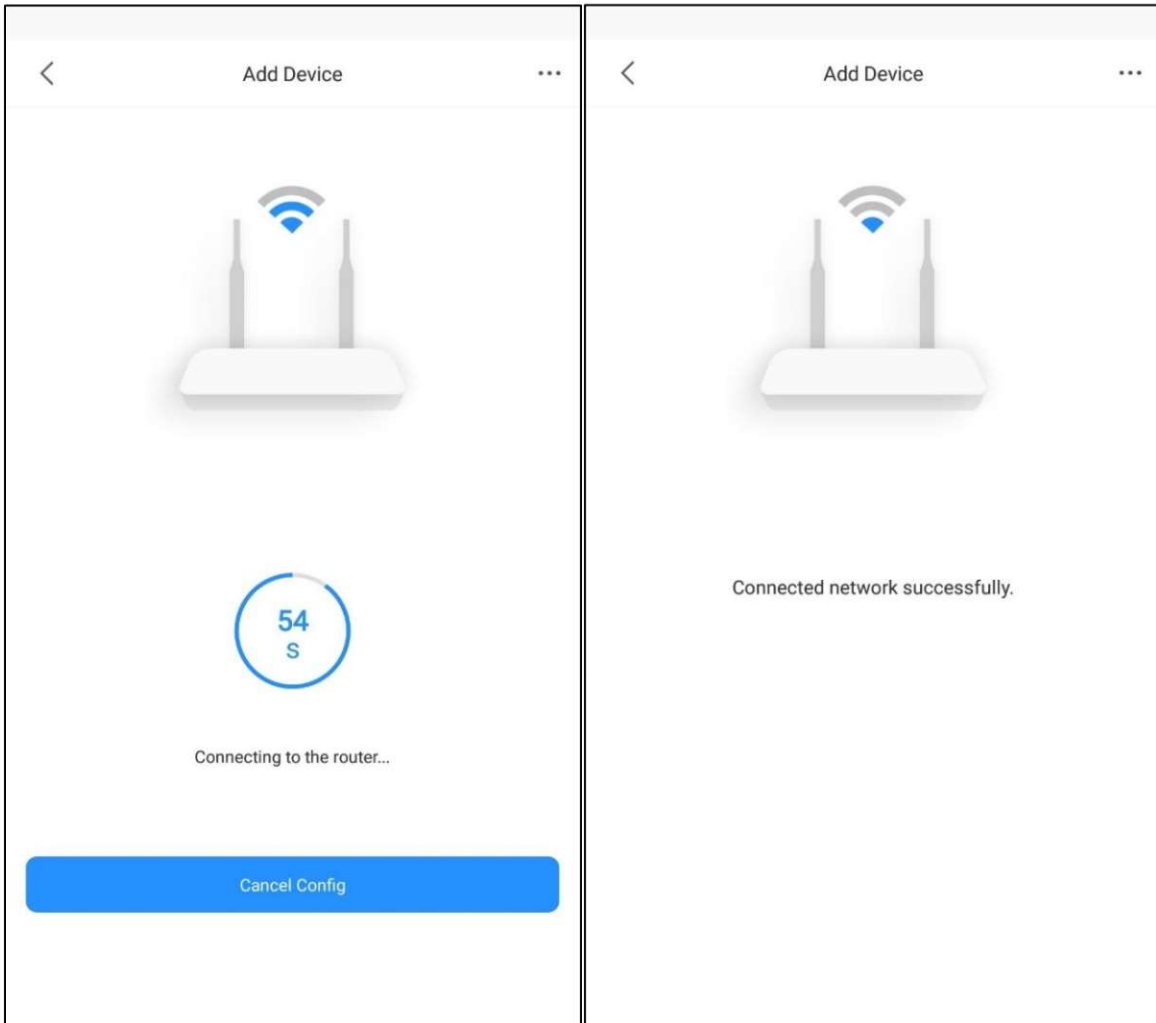

Step 11

Name the device and select the time zone.

The image displays two side-by-side screenshots of a mobile application interface, likely for configuring a device.

The left screenshot shows the "Add Device" screen. At the top, there is a back arrow on the left, the text "Add Device" in the center, and a "Save" button on the right. Below the header is a text input field labeled "Device Name" with the placeholder text "Example Name" and a small circular icon to its right. The rest of the screen is a large, empty light gray area.

The right screenshot shows the "Time Zone" settings screen. At the top, there is a back arrow on the left and the text "Time Zone" in the center. Below the header is a dropdown menu labeled "Time Zone (UTC-06:00)Central time (United States a..." with a right-pointing chevron. Below the dropdown is a "DST" label followed by a toggle switch that is currently turned off. Below the toggle is the text "DST time will be adjusted automatically after it is enabled." At the bottom of the screen is a large blue button labeled "Done".

Step 12

You should see the camera feed.

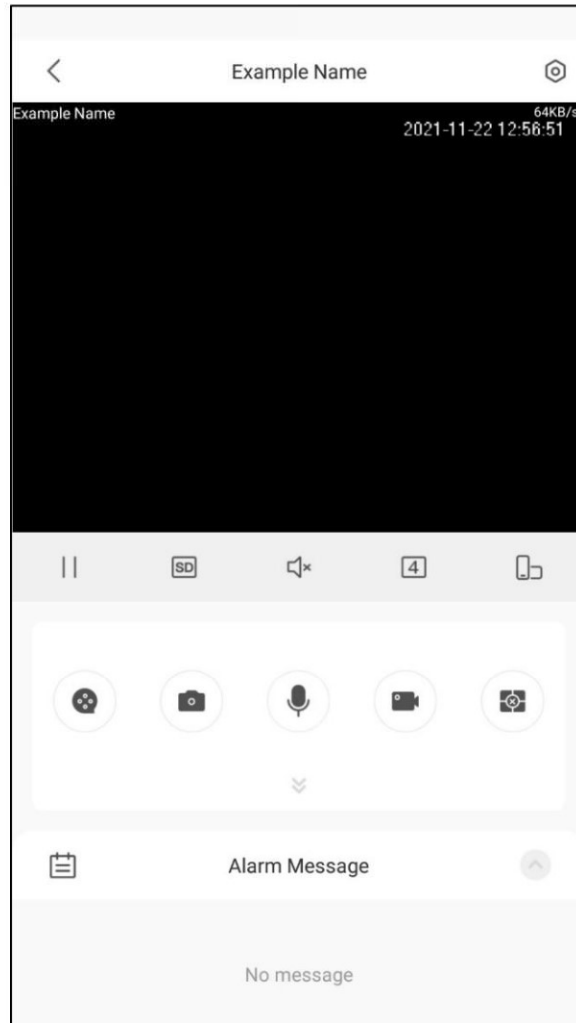

Camera Settings

Phone Alerts: Step 1

Turn on "Message Settings" to receive notifications on your phone.

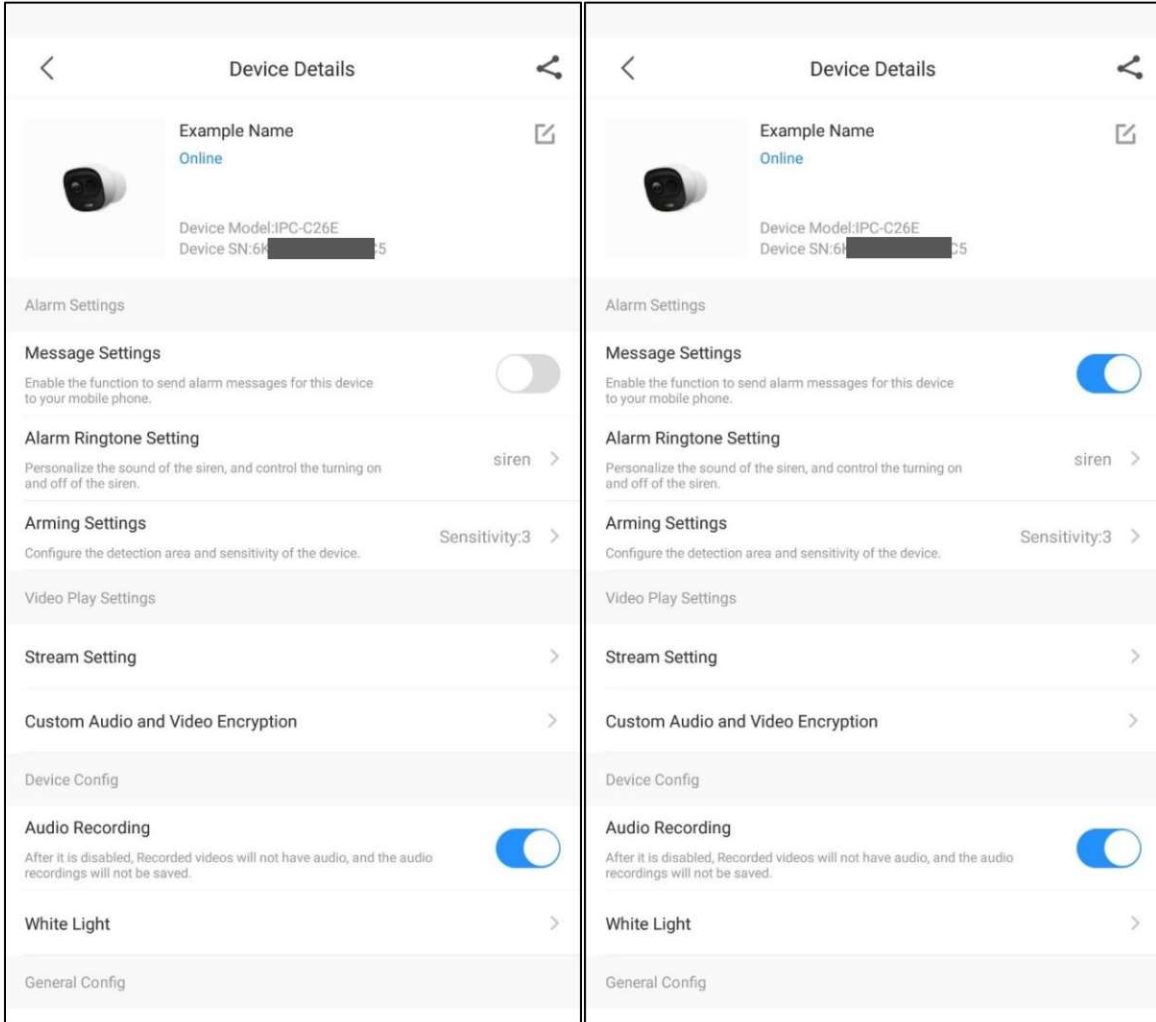

Motion Detection: Step 1

Go to “Arming Settings” to configure motion detection.

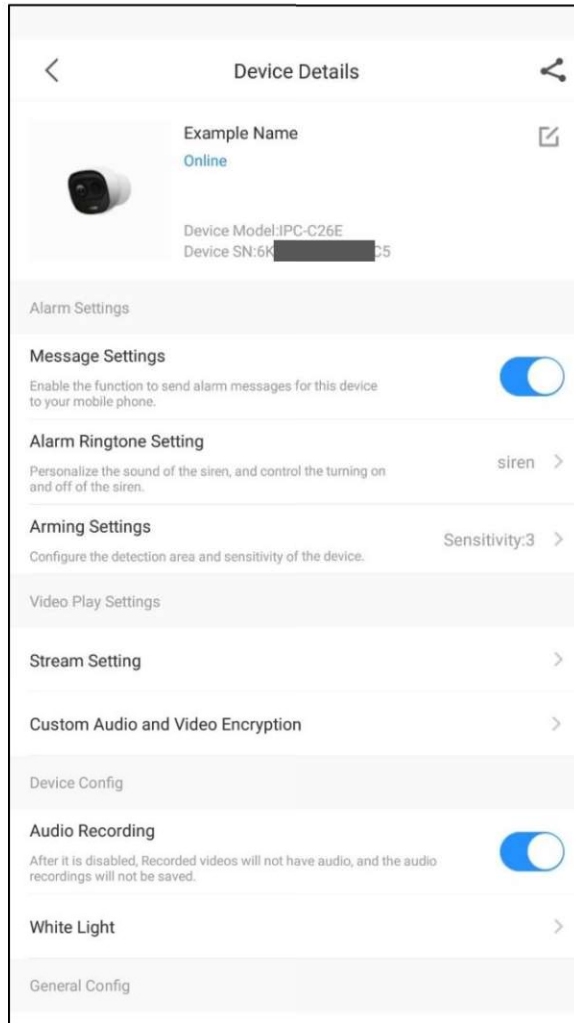

Motion Detection: Step 2

Motion detection should be turned on by default. You can adjust the sensitivity (1-6), and the area in which the camera will detect motion.

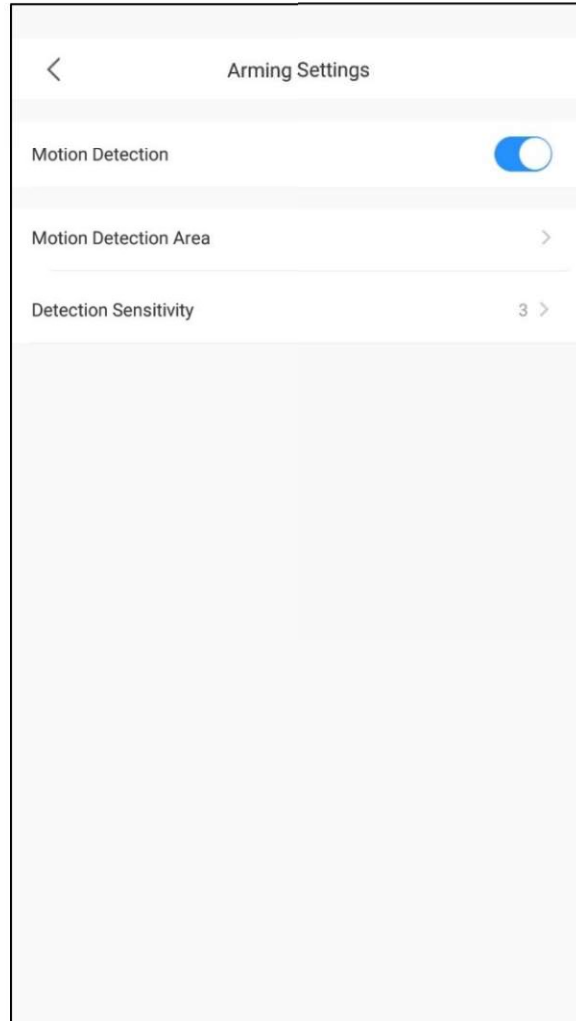

Motion Detection: Step 3

To configure the area in which the camera will detect motion, fill in the squares. The brush icon on the right is used to add squares, the mirror in the middle inverts your selection, and the eraser removes squares.

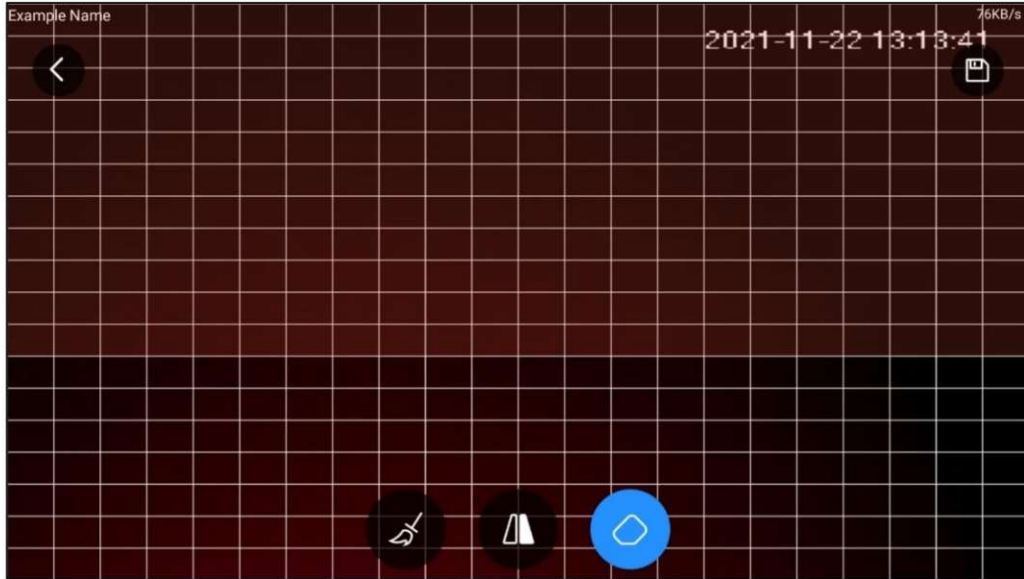

White Light: Step 1

Go to "White Light" to configure the camera light.



White Light: Step 2

The camera light can be linked to motion detection. You can adjust the brightness (1-4).

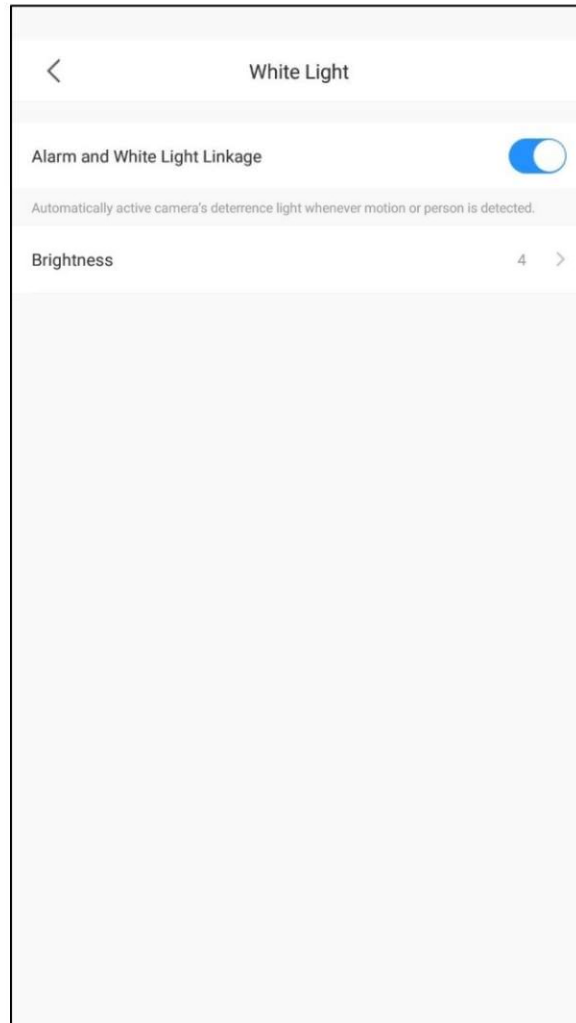

Alarm Ringtone: Step 1

Go to “Alarm Ringtone Setting”.



Alarm Ringtone: Step 1

You can turn on a siren sound. Be aware that it makes a very loud noise whenever motion is detected.

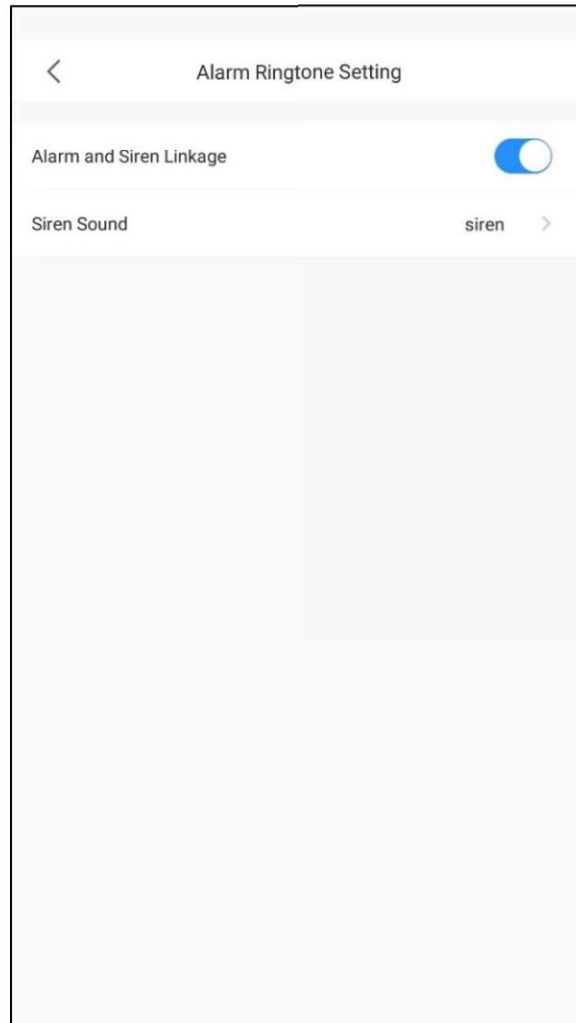

Shared Users: Step 1

Go to "Device Sharing".



Shared Users: Step 2

Enter the email address of the user you want to share the camera with. You can select the share permissions for each user you add, up to 6 users.

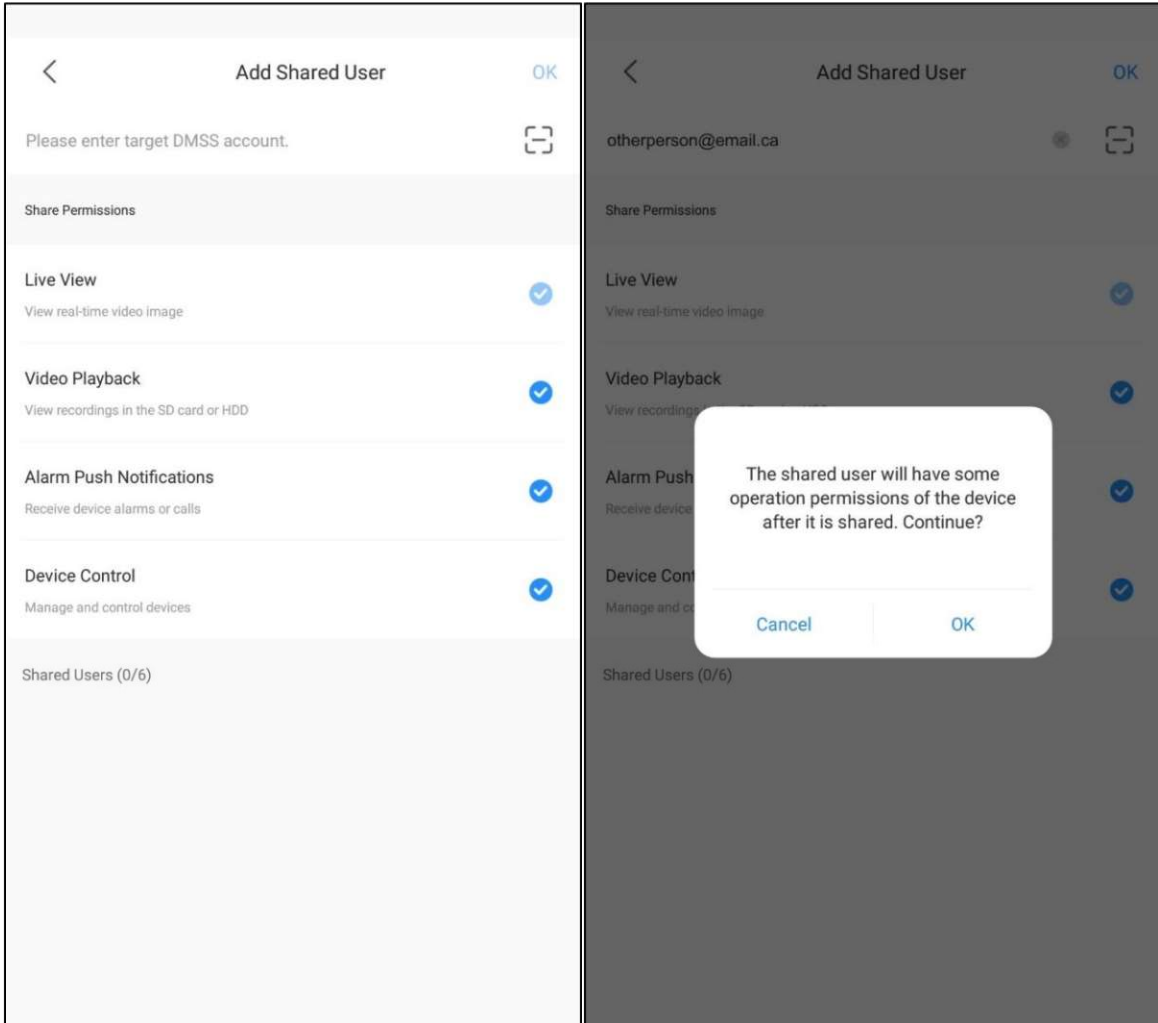

Shared Users: Step 1

You can view users that have been added at the bottom of the menu. Swipe left to remove them.

